

Providence Living at The Views

FAMILY SOCIAL 2024



Providence Living
Honouring every life story



The Basics



Who

Publicly subsidized care for anyone 18 or older meeting MOH Eligibility.

What

- 156 bed LTC home consisting of 13 self-contained households made up of 12 single occupancy bedrooms.
- Utilizing a social-relational model of care versus task driven staff centric.
- Opportunities to bring the community and children into the space.
- Strong partnership with Indigenous community.

When

Move in July 8, 2024.



Courtyard Level



Third Floor

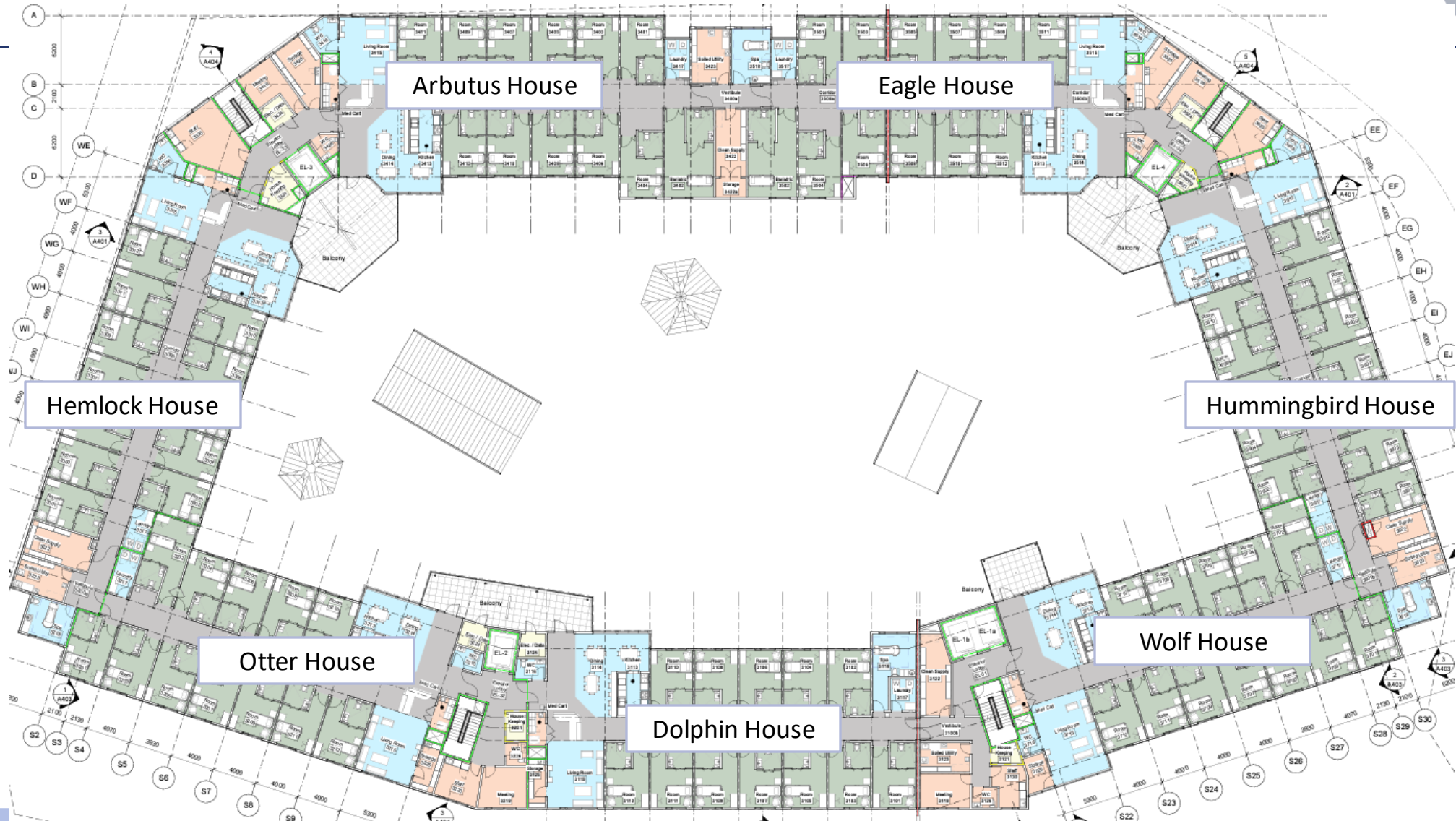

Main Street



Main street features:

1. Bistro
2. Community Hall
3. Wellness Centre
4. Art Studio
5. Grocery Store
6. Salon
7. Multipurpose Room
8. Medical Room
9. Main Street Plaza

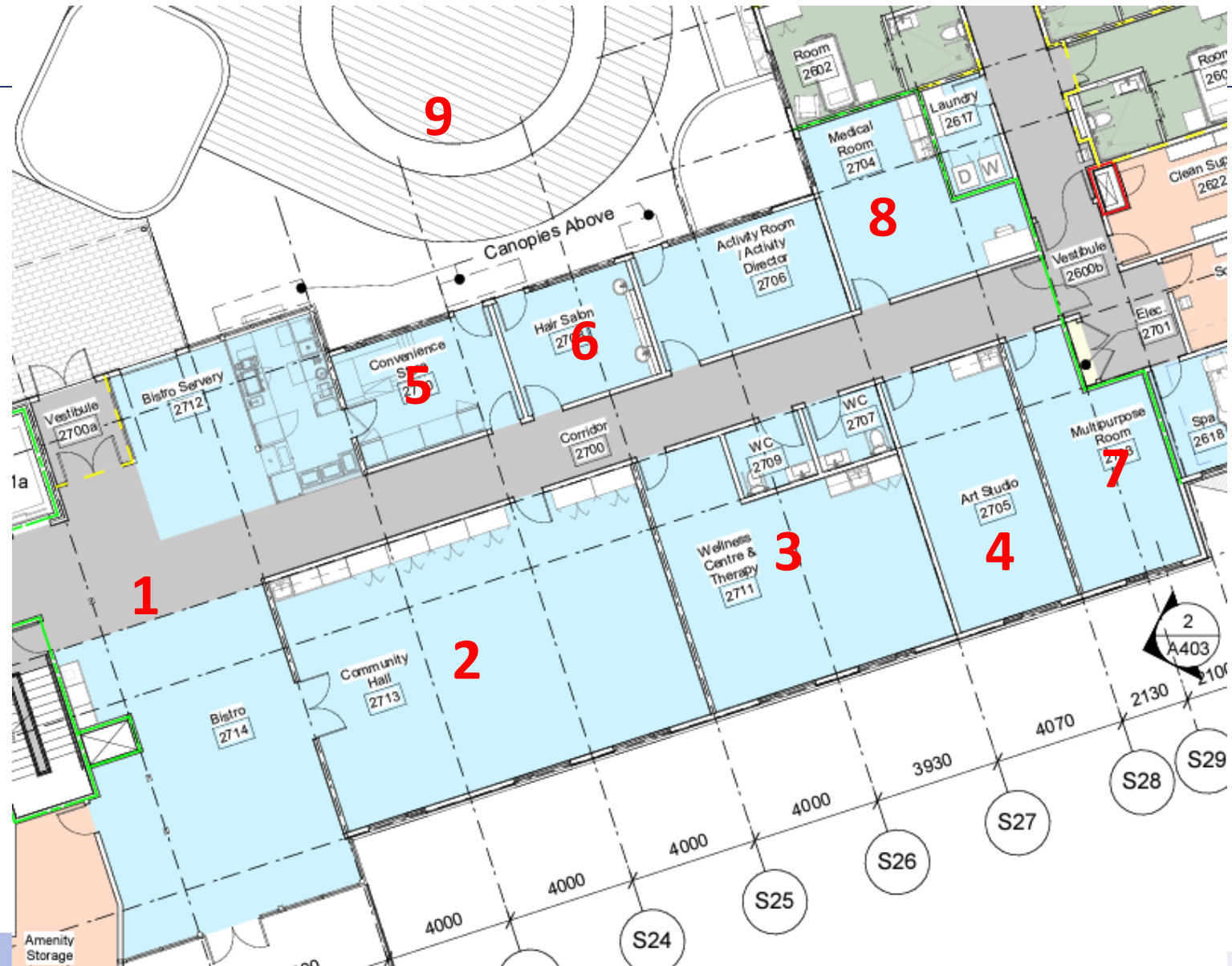

Room Placement Process



Step 1: Resident Household Preferences Survey

- Surveys completed by residents, families and staff answering questions about the preferences residents have for what the households would look like. Families and staff were asked to answer from their impression of the residents' perspective
- Results from these surveys informed what items to prioritize when organizing the households.

Step 2: Resident Care Needs

- Looked closely at each residents' care needs including personal care, mobility, and assistance needed for daily activities to ensure a balance workload in each household.

Step 3: Staff Working Group

- Staff gave feedback on over 30 categories of resident preferences from their perspective including things like: which residents get along/have relationships, which residents need lower stimulation, who enjoys being outdoors, daily routines and activity preferences, social preferences, etc.
- This working group met several times from October to January.

Step 4: Resident and Family Feedback

- Asked residents and families to share their 'must haves' and 'nice to haves'.

Step 5: Final Tweaks

- We will continue to make small tweaks to the resident placements as our community changes until move day.



Real Time Locating System



One of the unique features to support our residents moving freely about will be our real time locating system (RTLS). Each resident will be assigned a “watch” or a “pendant.”

These will be programmed to allow or restrict access. For most residents, access will be granted to community areas and their individual households and restricted for other households. If residents want to visit friends in other households, they will need to phone or knock on the door to be granted access.



Which would your family member prefer?

Thank You

QUESTIONS?

